



Lowther Road

Stanmore

Offers over £325,000

Davidson Frost-Wellings are delighted to present this two bedroom first floor maisonette situated within a minutes' walk to Queensbury Station which is easily accessible to Central London. This property also has a private garden.

Potential rental income of £1900 pcm.

Harrow council tax band C.

Leasehold with approximately 150 years remaining.

Ground rent £200 pa.

Service charge £600 pa.

Viewing

Please contact our Davidson Frost-Wellings Office on 020 8954 8806 if you wish to arrange a viewing appointment for this property or require further information.

- Two bedrooms
- Bathroom
- Private garden
- Long lease
- Close to Queensbury Station
- First floor



Floor Plan

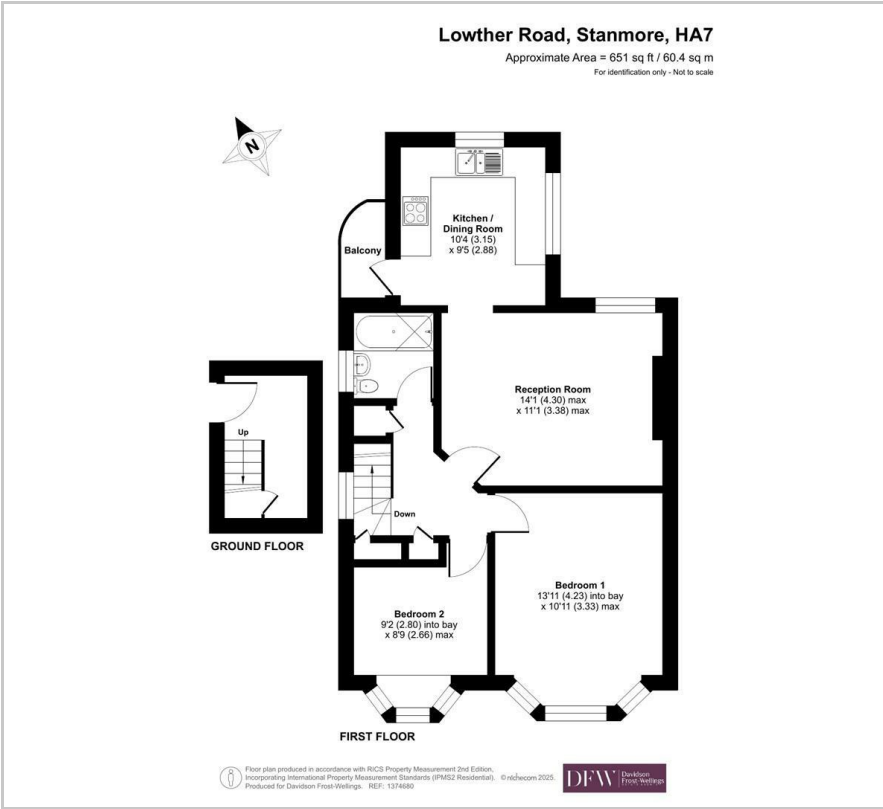

Area Map

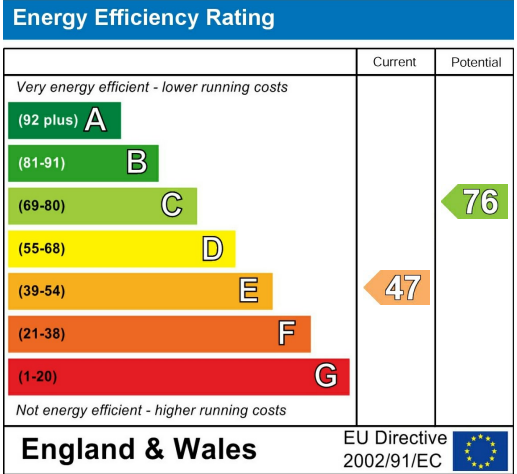

These particulars, whilst believed to be accurate are set out as a general outline only for guidance and do not constitute any part of an offer or contract. Intending purchasers should not rely on them as statements of representation of fact, but must satisfy themselves by inspection or otherwise as to their accuracy. No person in this firms employment has the authority to make or give any representation or warranty in respect of the property.